

# FILL-IN™

## Technique Summary

### Fill-In Unidose® Syringe Activation

Each syringe contains enough material for a 3-unit bridge.

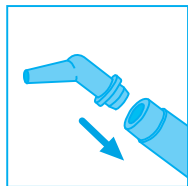

1. Insert applicator tip for precise material placement.

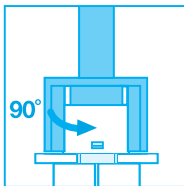

2. Twist tip 90 degrees.

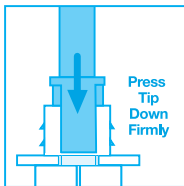

Press Tip Down Firmly

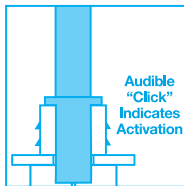

3. Press tip down firmly through notch until "click" is heard. Material is now ready to dispense.

# Just a Minute...

## 25 SECONDS

STEP 2: Fill-In sets quickly. After an additional 25 seconds (or a total of 1 minute), remove from the mouth.

## 35 SECONDS

STEP 1: Fill-In works quickly. Within the first 35 seconds, activate syringe, dispense material and insert in the mouth.



# Quick Finish and Polish



1. Contour with diamond bur.



2. Finish and polish to a high luster with flexible disc system\* or polishing brush\*.



3. Cement into place\*.

#### \*RECOMMENDED PRODUCTS:

*Bonding* – OptiBond® Solo Plus™

*Flowable Composite* – Point 4 Flowable™ or Revolution® Formula 2™

*Curing* – Demetron 501 (halogen) or L.E.Demetron1 (LED)

*Finishing and Polishing* – OptiDisc® (translucent disc system) or

OccluBrush® (particle-embedded brush system)

*Cementation* – TempBond® Clear™ or TempBond NE™

\*\*CAUTION: Uncured methacrylate resin may cause contact dermatitis and damage the pulp. Avoid contact with skin, eyes and soft tissue.

Wash thoroughly with water after contact.

## Repairing Temporaries:

Steps 1-5

## Adding To Short Margins:

Steps 3-5



1. Clean and abrade area.



2. Apply bonding resin\*\* and light cure.



3. Apply flowable composite.\*  
Reseat temporary in mouth and light cure.



4. Remove temporary and light cure extraorally.



5. Finish and polish.